

DKUIV - DIALOCK® 2-way diaphragm valve

DIALOCK® diaphragm valve with female union ends for solvent welding, metric series

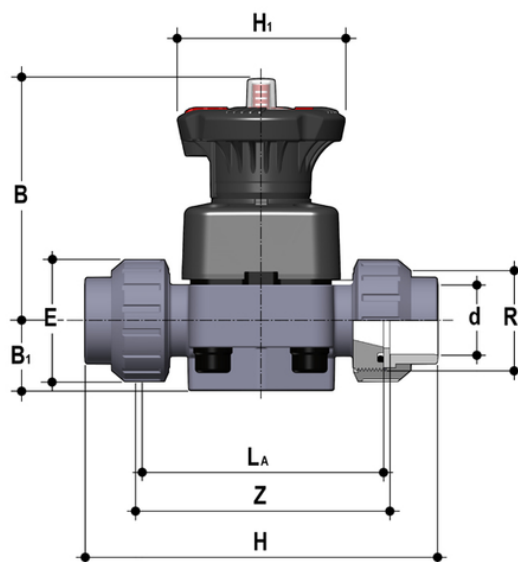

EPDM

| Objednací číslo | Materiál | Kategorie | Série | d | DN | PN | B | B (5:1) | E | H | H (5:1) | La | product.detail.attribute.R[5:1] | Z | g |
|-----------------|--------------|-----------|-------------|----|----|----|-----|---------|----|-----|---------|-----|---------------------------------|-----|------|
| DKUIV020E | PVC-U system | Armatury | DK DN 15÷65 | 20 | 15 | 10 | 102 | 25 | 41 | 129 | 80 | 90 | 1" | 100 | 500 |
| DKUIV025E | PVC-U system | Armatury | DK DN 15÷65 | 25 | 20 | 10 | 105 | 30 | 50 | 154 | 80 | 108 | 1"1/4 | 116 | 562 |
| DKUIV032E | PVC-U system | Armatury | DK DN 15÷65 | 32 | 25 | 10 | 114 | 33 | 58 | 168 | 80 | 116 | 1"1/2 | 124 | 790 |
| DKUIV040E | PVC-U system | Armatury | DK DN 15÷65 | 40 | 32 | 10 | 119 | 30 | 72 | 192 | 80 | 134 | 2" | 140 | 916 |
| DKUIV050E | PVC-U system | Armatury | DK DN 15÷65 | 50 | 40 | 10 | 149 | 35 | 79 | 222 | 120 | 154 | 2"1/4 | 160 | 1768 |
| DKUIV063E | PVC-U system | Armatury | DK DN 15÷65 | 63 | 50 | 10 | 172 | 46 | 98 | 266 | 120 | 184 | 2"3/4 | 190 | 2668 |

EPDM

| Objednací číslo | Materiál | Kategorie | Série | d | DN | PN | B | B (5:1) | E | H | H (5:1) | La | product.detail.attribute.R[5:1] | Z | g |
|-----------------|--------------|-----------|-------------|----|----|----|-----|---------|----|-----|---------|-----|---------------------------------|-----|-----|
| DKUIV020E0SF | PVC-U system | Armatury | DK DN 15÷65 | 20 | 15 | 10 | 102 | 25 | 41 | 129 | 80 | 90 | 1" | 100 | 500 |
| DKUIV025E0SF | PVC-U system | Armatury | DK DN 15÷65 | 25 | 20 | 10 | 105 | 30 | 50 | 154 | 80 | 108 | 1"1/4 | 116 | 562 |

DKUIV – DIALOCK® 2-way diaphragm valve

| Objednací číslo | Materiál | Kategorie | Série | d | DN | PN | B | B (5:1) | E | H | H (5:1) | La | product.detail.attribute.R[5:1] | Z | g |
|-----------------|--------------|-----------|-------------|----|----|----|-----|---------|----|-----|---------|-----|---------------------------------|-----|------|
| DKUIV032E0SF | PVC-U system | Armatury | DK DN 15÷65 | 32 | 25 | 10 | 114 | 33 | 58 | 168 | 80 | 116 | 1"1/2 | 124 | 790 |
| DKUIV040E0SF | PVC-U system | Armatury | DK DN 15÷65 | 40 | 32 | 10 | 119 | 30 | 72 | 192 | 80 | 134 | 2" | 140 | 916 |
| DKUIV050E0SF | PVC-U system | Armatury | DK DN 15÷65 | 50 | 40 | 10 | 149 | 35 | 79 | 222 | 120 | 154 | 2"1/4 | 160 | 1768 |
| DKUIV063E0SF | PVC-U system | Armatury | DK DN 15÷65 | 63 | 50 | 10 | 172 | 46 | 98 | 266 | 120 | 184 | 2"3/4 | 190 | 2668 |

FKM

| Objednací číslo | Materiál | Kategorie | Série | d | DN | PN | B | B (5:1) | E | H | H (5:1) | La | product.detail.attribute.R[5:1] | Z | g |
|-----------------|--------------|-----------|-------------|----|----|----|-----|---------|----|-----|---------|-----|---------------------------------|-----|------|
| DKUIV020F | PVC-U system | Armatury | DK DN 15÷65 | 20 | 15 | 10 | 102 | 25 | 41 | 129 | 80 | 90 | 1" | 100 | 500 |
| DKUIV025F | PVC-U system | Armatury | DK DN 15÷65 | 25 | 20 | 10 | 105 | 30 | 50 | 154 | 80 | 108 | 1"1/4 | 116 | 562 |
| DKUIV032F | PVC-U system | Armatury | DK DN 15÷65 | 32 | 25 | 10 | 114 | 33 | 58 | 168 | 80 | 116 | 1"1/2 | 124 | 790 |
| DKUIV040F | PVC-U system | Armatury | DK DN 15÷65 | 40 | 32 | 10 | 119 | 30 | 72 | 192 | 80 | 134 | 2" | 140 | 916 |
| DKUIV050F | PVC-U system | Armatury | DK DN 15÷65 | 50 | 40 | 10 | 149 | 35 | 79 | 222 | 120 | 154 | 2"1/4 | 160 | 1768 |
| DKUIV063F | PVC-U system | Armatury | DK DN 15÷65 | 63 | 50 | 10 | 172 | 46 | 98 | 266 | 120 | 184 | 2"3/4 | 190 | 2668 |

PTFE

| Objednací číslo | Materiál | Kategorie | Série | d | DN | PN | B | B (5:1) | E | H | H (5:1) | La | product.detail.attribute.R[5:1] | Z | g |
|-----------------|--------------|-----------|-------------|----|----|----|-----|---------|----|-----|---------|-----|---------------------------------|-----|------|
| DKUIV020P | PVC-U system | Armatury | DK DN 15÷65 | 20 | 15 | 10 | 102 | 25 | 41 | 129 | 80 | 90 | 1" | 100 | 500 |
| DKUIV025P | PVC-U system | Armatury | DK DN 15÷65 | 25 | 20 | 10 | 105 | 30 | 50 | 154 | 80 | 108 | 1"1/4 | 116 | 562 |
| DKUIV032P | PVC-U system | Armatury | DK DN 15÷65 | 32 | 25 | 10 | 114 | 33 | 58 | 168 | 80 | 116 | 1"1/2 | 124 | 790 |
| DKUIV040P | PVC-U system | Armatury | DK DN 15÷65 | 40 | 32 | 10 | 119 | 30 | 72 | 192 | 80 | 134 | 2" | 140 | 916 |
| DKUIV050P | PVC-U system | Armatury | DK DN 15÷65 | 50 | 40 | 10 | 149 | 35 | 79 | 222 | 120 | 154 | 2"1/4 | 160 | 1768 |
| DKUIV063P | PVC-U system | Armatury | DK DN 15÷65 | 63 | 50 | 10 | 172 | 46 | 98 | 266 | 120 | 184 | 2"3/4 | 190 | 2668 |

DKUIV – DIALOCK® 2-way diaphragm valve

PTFE

| Objednáací číslo | Materiál | Kategorie | Série | d | DN | PN | B | B (5:1) | E | H | H (5:1) | La | product.detail.attribute.R[5:1] | Z | g |
|------------------|--------------|-----------|-------------|----|----|----|-----|---------|----|-----|---------|-----|---------------------------------|-----|------|
| DKUIV020POSF | PVC-U system | Armatury | DK DN 15÷65 | 20 | 15 | 10 | 102 | 25 | 41 | 129 | 80 | 90 | 1" | 100 | 500 |
| DKUIV025POSF | PVC-U system | Armatury | DK DN 15÷65 | 25 | 20 | 10 | 105 | 30 | 50 | 154 | 80 | 108 | 1 1/4" | 116 | 562 |
| DKUIV032POSF | PVC-U system | Armatury | DK DN 15÷65 | 32 | 25 | 10 | 114 | 33 | 58 | 168 | 80 | 116 | 1 1/2" | 124 | 790 |
| DKUIV040POSF | PVC-U system | Armatury | DK DN 15÷65 | 40 | 32 | 10 | 119 | 30 | 72 | 192 | 80 | 134 | 2" | 140 | 916 |
| DKUIV050POSF | PVC-U system | Armatury | DK DN 15÷65 | 50 | 40 | 10 | 149 | 35 | 79 | 222 | 120 | 154 | 2 1/4" | 160 | 1768 |
| DKUIV063POSF | PVC-U system | Armatury | DK DN 15÷65 | 63 | 50 | 10 | 172 | 46 | 98 | 266 | 120 | 184 | 2 3/4" | 190 | 2668 |

DKUIV – DIALOCK® 2-way diaphragm valve

- **High visibility graduated optical position indicator** protected by a transparent cap with seal O-Ring
- **Customisation plate:** the customisation lets you identify the valve on the system according to specific needs
- **DIALOCK® SYSTEM:** innovative handwheel with a patented immediate and ergonomic operating locking device that allows it **to be adjusted and locked in over 300 positions**
- **Handwheel and bonnet in** high mechanical strength and chemically resistant **PP-GR**, providing full protection by isolating all internal metal parts from contact with external agents
- **Floating pin connection** between the control screw and diaphragm to prevent concentrated loads, improve the seal and extend its lifetime
- **New design of valve body interior: substantially increased flow coefficient** and reduced pressure drop. The degree of efficiency reached has also **enabled the size and weight of the valve to be reduced**
- **Adjustment linearity:** the internal profiles of the valve also greatly improve its characteristic curve, resulting in **extremely sensitive and precise adjustment** along the entire stroke of the shutter
- **Valve anchoring** bracket **integrated in the body**, with threaded metal inserts allowing **simple panel or wall mounting** using the PMDK mounting plate (supplied as an accessory)

- Connection system for solvent weld, threaded and flanged joints
- **Optimised fluid dynamic design:** maximum output flow rate thanks to the optimised efficiency of the fluid dynamics that characterise the new internal geometry of the body
- **Internal components in metal, totally isolated from the fluid** and external environment
- **Modularity of the range:** only 2 handwheel and 4 diaphragm and bonnet sizes for 7 different valve sizes
- Non-rising handwheel that stays at the same height during rotation, equipped with a graduated optical indicator protected by a transparent PVC cap with seal O-Ring
- Bonnet fastening screws in stainless steel protected against the external environment by PE plugs. Absence of metal parts exposed to the external environment to prevent any risk of corrosion.
- **CDSA** (Circular Diaphragm Sealing Angle) system that, thanks to the uniform distribution of shutter pressure on the diaphragm seal, offers the following advantages:
 - reduction in the tightening torque of the screws fixing the actuator to the valve body
 - reduced mechanical stress on all valve components (actuator, body and diaphragm)
 - easy to clean valve interior
 - low risk of the accumulation of deposits, contamination or damage to the diaphragm due to crystallisation
 - operating torque reduction