

# CMIF/CP NO – PNEUMATICALLY ACTUATED COMPACT DIAPHRAGM VALVE DN 12:15

Pneumatically actuated diaphragm valve with metric plain socket ends for socket welding, Normally Open.

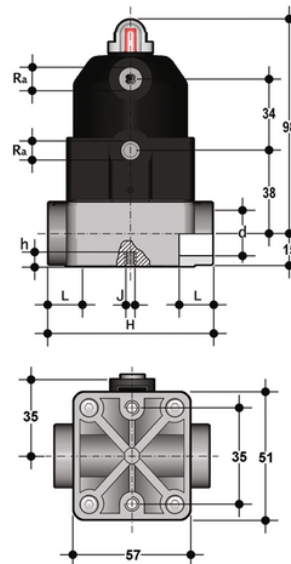

## EPDM

| Objednací číslo | Materiál                              | Kategorie                                | Série                 | d  | DN | PN | product.detail.attribute.Ra | L  | H  | product.detail.attribute.h | product.detail.attribute.h |
|-----------------|---------------------------------------|--|-----------------------|----|----|----|-----------------------------|----|----|----------------------------|----------------------------|
| CMIFNO016E      | FLS<br>Measurement<br>Instrumentation | Pneumaticky ovládané pohonované armatury | CM/<br>CP<br>DN 12÷15 | 16 | 12 | 6  | G 1/4"                      | 14 | 75 | 8                          | M5                         |
| CMIFNO020E      | FLS<br>Measurement<br>Instrumentation | Pneumaticky ovládané pohonované armatury | CM/<br>CP<br>DN 12÷15 | 20 | 15 | 6  | G 1/4"                      | 16 | 75 | 8                          | M5                         |

## FKM

| Objednací číslo | Materiál                              | Kategorie                                | Série                 | d  | DN | PN | product.detail.attribute.Ra | L  | H  | product.detail.attribute.h | product.detail.attribute.h |
|-----------------|---------------------------------------|--|-----------------------|----|----|----|-----------------------------|----|----|----------------------------|----------------------------|
| CMIFNO016F      | FLS<br>Measurement<br>Instrumentation | Pneumaticky ovládané pohonované armatury | CM/<br>CP<br>DN 12÷15 | 16 | 12 | 6  | G 1/4"                      | 14 | 75 | 8                          | M5                         |
| CMIFNO020F      | FLS<br>Measurement<br>Instrumentation | Pneumaticky ovládané pohonované armatury | CM/<br>CP<br>DN 12÷15 | 20 | 15 | 6  | G 1/4"                      | 16 | 75 | 8                          | M5                         |

# CMIF/CP NO – PNEUMATICALLY ACTUATED COMPACT DIAPHRAGM VALVE DN 12:15

## PTFE

| Objednáací číslo | Materiál                              | Kategorie   | Série                    | d  | DN | PN | product.detail.attribute.Ra | L  | H  | product.detail.attribute.h | product.detail.attri |
|------------------|---------------------------------------|---|--------------------------|----|----|----|-----------------------------|----|----|----------------------------|----------------------|
| CMIFNO016P       | FLS<br>Measurement<br>Instrumentation | Pneumaticky<br>ovládané<br>pohonované<br>armatury | CM/<br>CP<br>DN<br>12÷15 | 16 | 12 | 6  | G 1/4"                      | 14 | 75 | 8                          | M5                   |
| CMIFNO020P       | FLS<br>Measurement<br>Instrumentation | Pneumaticky<br>ovládané<br>pohonované<br>armatury | CM/<br>CP<br>DN<br>12÷15 | 20 | 15 | 6  | G 1/4"                      | 16 | 75 | 8                          | M5                   |

# CMIF/CP NO – PNEUMATICALLY ACTUATED COMPACT DIAPHRAGM VALVE DN 12:15

The new compact and light piston actuator in PP-GR makes the CM/CP the ideal choice for applications requiring very frequent valve operation and a long valve lifetime.

- Compact and lightweight piston actuator in PP-GR, free of exposed metallic parts, particularly suited for use in severe environmental and chemically aggressive conditions.
- High strength IXEF piston guarantees high reliability over time without maintenance.
- High visibility graduated optical position indicator protected by a transparent cap with a seal O-Ring.
- The valve is impervious to fluids containing impurities
- It has an high flow rate
- It can be installed in any position
- It has an extremely compact structure
- It is actuated by a dry running piston and does not require maintenance
- It has no protruding screws and is fully free of impurity deposits
- Allows for an easy diaphragm seal replacement
- The Standard version valve comes with a position indicator.